

# RIVERVIEW PLACE

520 N. CHRISTOPHER COLUMBUS BOULEVARD  
PHILADELPHIA, PA

**GROUND FLOOR RETAIL AVAILABLE  
FROM 1,007 TO 2,707 SF**



## LOCATION

520 N. Christopher Columbus Blvd.  
(At The Corner of Columbus Blvd. & Spring Garden St.)  
Philadelphia, PA

## PROPERTY HIGHLIGHTS

- **GROUND FLOOR RETAIL FROM 1,007 - 2,707 SF AVAILABLE**
- High Profile Corner
- 166,000 SF of Office Space Above
- Available Parking
- Excellent Access to I-76, I-676 & I-95
- One Block from Market Frankford Line
- Columbus Boulevard: 21,976 AVD
- Spring Garden Street: 20,693 AVD



**Gregory R. Bianchi**

Vice President

T. 215-701-3840

gbianchi@eusrealty.com

**Michele Grasso**

Managing Director

T. 215-701-3818

michelegrasso@eusrealty.com

**USREALTY**  
ASSOCIATES, INC.

A Full Service Real Estate Company

**Brandon Blue**

Sales Associate

T. 215-501-7305

bblue@eusrealty.com

120-124 E. Lancaster Avenue - Suite 101 - Ardmore - PA - 19003

T. 215-557-9900 F. 215-701-3839

[www.eusrealty.com](http://www.eusrealty.com)

The forgoing information was furnished by sources deemed reliable, but no warranty or representation as to its accuracy.  
Subject to errors, omission, changes of price, prior sale or withdrawal from market without notice.

# RIVERVIEW PLACE

520 N. CHRISTOPHER COLUMBUS BOULEVARD  
PHILADELPHIA, PA

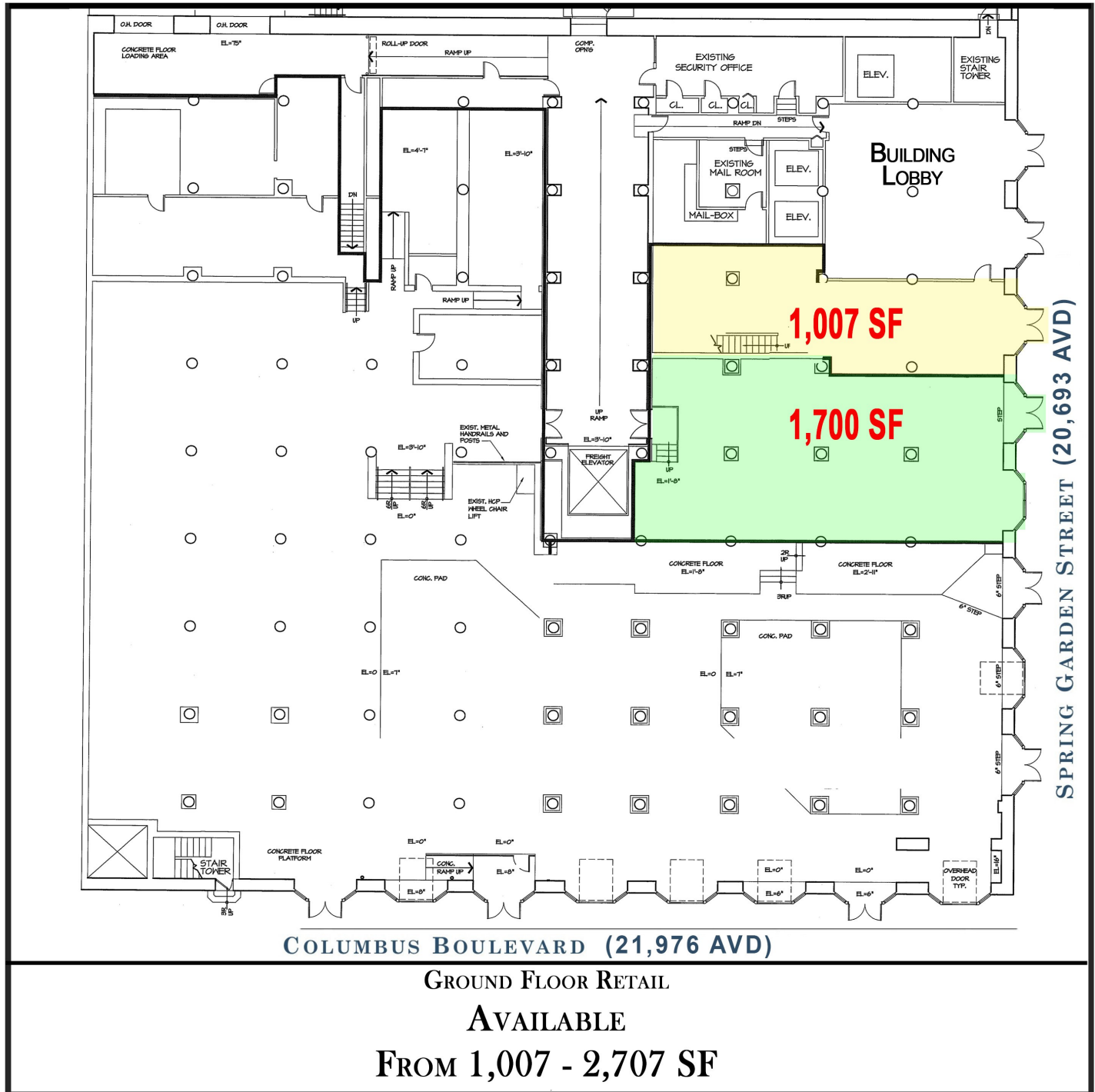

## PLEASE CONTACT:

**Gregory R. Bianchi**

Vice President

T. 215-701-3840

gbianchi@eusrealty.com

**Michele Grasso**

Managing Director

T. 215-701-3818

michelegrasso@eusrealty.com

**Brandon Blue**

Sales Associate

T. 215-501-7305

bblue@eusrealty.com

**USREALTY**  
ASSOCIATES, INC.  
A Full Service Real Estate Company

120-124 E. Lancaster Avenue - Suite 101 - Ardmore - PA - 19003

T.215-557-9900 F.215-701-3839

www.eusrealty.com

The forgoing information was furnished by sources deemed reliable, but no warranty or representation as to its accuracy.  
Subject to errors, omission, changes of price, prior sale or withdrawal from market without notice.



# RIVERVIEW PLACE

520 N. CHRISTOPHER COLUMBUS BOULEVARD  
PHILADELPHIA, PA

## AIRIAL RETAIL MAP



### PLEASE CONTACT:

**Gregory R. Bianchi**

Vice President

T. 215-701-3840

[gbianchi@eusrealty.com](mailto:gbianchi@eusrealty.com)

**Michele Grasso**

Managing Director

T. 215-701-3818

[michelegrasso@eusrealty.com](mailto:michelegrasso@eusrealty.com)

**Brandon Blue**

Sales Associate

T. 215-501-7305

[bblue@eusrealty.com](mailto:bblue@eusrealty.com)

**USREALTY**  
ASSOCIATES, INC.  
A Full Service Real Estate Company

120-124 E. Lancaster Avenue - Suite 101 - Ardmore - PA - 19003

T. 215-557-9900 F. 215-701-3839

[www.eusrealty.com](http://www.eusrealty.com)

The forgoing information was furnished by sources deemed reliable, but no warranty or representation as to its accuracy.  
Subject to errors, omission, changes of price, prior sale or withdrawal from market without notice.



# RIVERVIEW PLACE

520 N. CHRISTOPHER COLUMBUS BOULEVARD  
PHILADELPHIA, PA

## TRANSPORTATION MAP



### PLEASE CONTACT:

**Gregory R. Bianchi**

Vice President

T. 215-701-3840

gbianchi@eusrealty.com

**Michele Grasso**

Managing Director

T. 215-701-3818

michelegrasso@eusrealty.com

**Brandon Blue**

Sales Associate

T. 215-501-7305

bblue@eusrealty.com

**USREALTY**  
ASSOCIATES, INC.  
A Full Service Real Estate Company

120-124 E. Lancaster Avenue - Suite 101 - Ardmore - PA - 19003

T. 215-557-9900 F. 215-701-3839

[www.eusrealty.com](http://www.eusrealty.com)