

RIVERVIEW PLACE

520 N. CHRISTOPHER COLUMBUS BOULEVARD
PHILADELPHIA, PA

**GROUND FLOOR RETAIL AVAILABLE
FROM 1,007 TO 2,707 SF**



LOCATION

520 N. Christopher Columbus Blvd.
(At The Corner of Columbus Blvd. & Spring Garden St.)
Philadelphia, PA

PROPERTY HIGHLIGHTS

- **GROUND FLOOR RETAIL FROM 1,007 - 2,707 SF AVAILABLE**
- High Profile Corner
- 166,000 SF of Office Space Above
- Available Parking
- Excellent Access to I-76, I-676 & I-95
- One Block from Market Frankford Line
- Columbus Boulevard: 21,976 AVD
- Spring Garden Street: 20,693 AVD



Gregory R. Bianchi

Vice President

T. 215-701-3840

gbianchi@eusrealty.com

Michele Grasso

Managing Director

T. 215-701-3818

michelegrasso@eusrealty.com

USREALTY
ASSOCIATES, INC.

A Full Service Real Estate Company

Brandon Blue

Sales Associate

T. 215-501-7305

bblue@eusrealty.com

120-124 E. Lancaster Avenue - Suite 101 - Ardmore - PA - 19003

T. 215-557-9900 F. 215-701-3839

www.eusrealty.com

The forgoing information was furnished by sources deemed reliable, but no warranty or representation as to its accuracy.
Subject to errors, omission, changes of price, prior sale or withdrawal from market without notice.

RIVERVIEW PLACE

520 N. CHRISTOPHER COLUMBUS BOULEVARD
PHILADELPHIA, PA

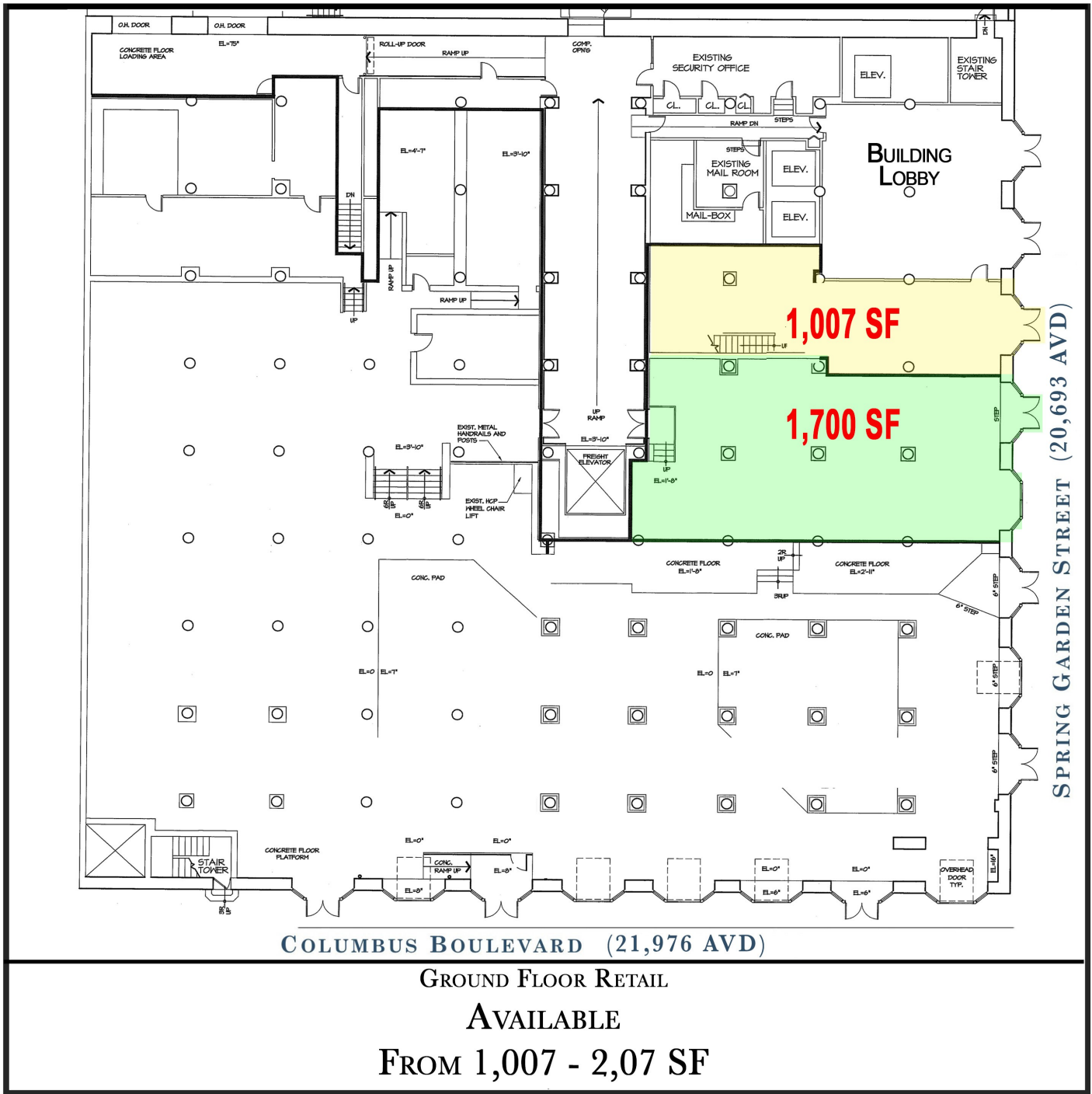

PLEASE CONTACT:

Gregory R. Bianchi

Vice President

T. 215-701-3840

gbianchi@eusrealty.com

Michele Grasso

Managing Director

T. 215-701-3818

michelegrasso@eusrealty.com

Brandon Blue

Sales Associate

T. 215-501-7305

bblue@eusrealty.com

USREALTY
ASSOCIATES, INC.
A Full Service Real Estate Company

120-124 E. Lancaster Avenue - Suite 101 - Ardmore - PA - 19003

T. 215-557-9900 F. 215-701-3839

www.eusrealty.com

The foregoing information was furnished by sources deemed reliable, but no warranty or representation as to its accuracy.
Subject to errors, omission, changes of price, prior sale or withdrawal from market without notice.

RIVERVIEW PLACE

520 N. CHRISTOPHER COLUMBUS BOULEVARD
PHILADELPHIA, PA

ARIAL RETAIL MAP

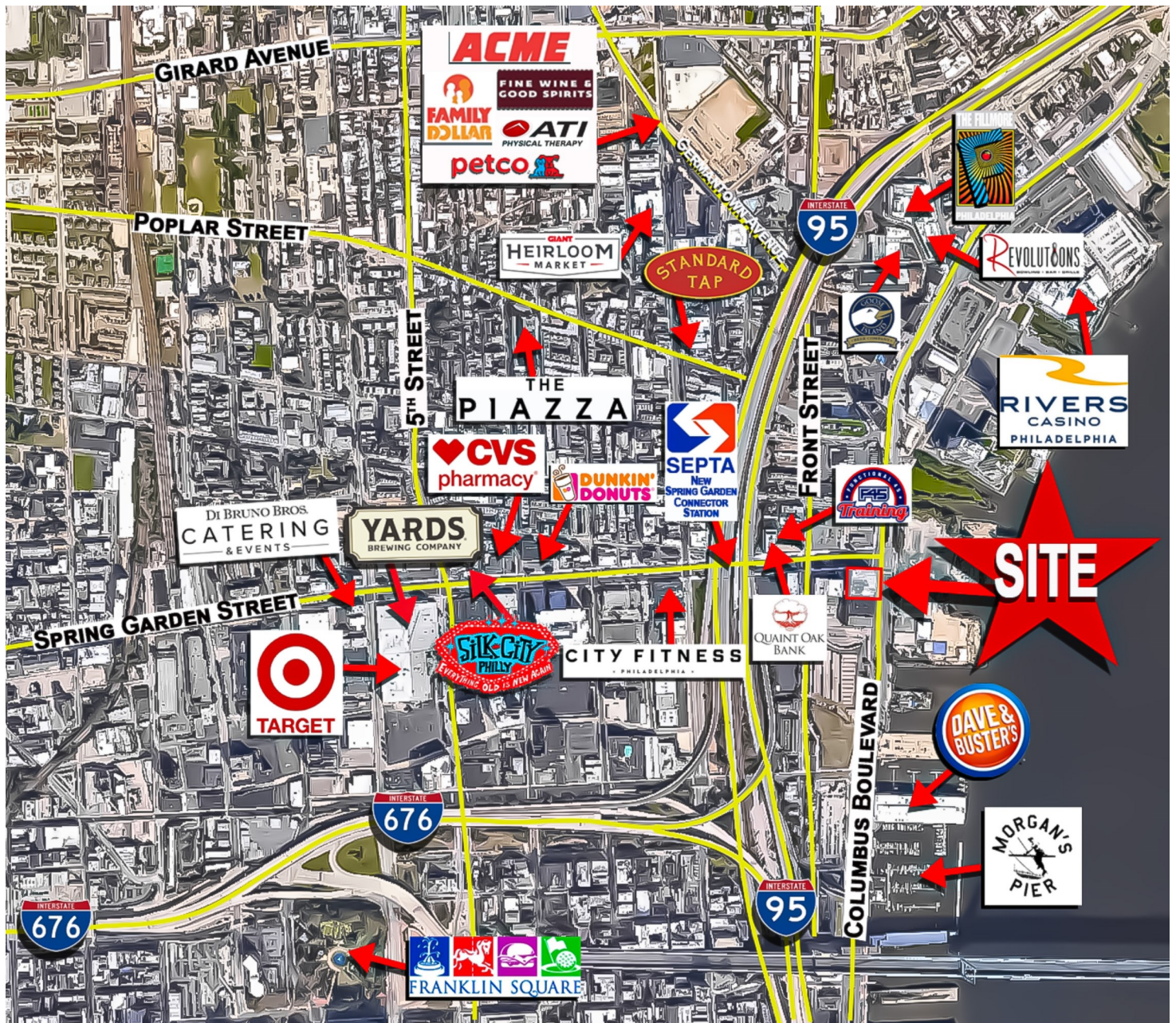

PLEASE CONTACT:

Gregory R. Bianchi

Vice President

T. 215-701-3840

gbianchi@eusrealty.com

Michele Grasso

Managing Director

T. 215-701-3818

michelegrasso@eusrealty.com

Brandon Blue

Sales Associate

T. 215-501-7305

bblue@eusrealty.com

USREALTY
ASSOCIATES, INC.
A Full Service Real Estate Company

120-124 E. Lancaster Avenue - Suite 101 - Ardmore - PA - 19003

T. 215-557-9900 F. 215-701-3839

www.eusrealty.com

The forgoing information was furnished by sources deemed reliable, but no warranty or representation as to its accuracy.
Subject to errors, omission, changes of price, prior sale or withdrawal from market without notice.

RIVERVIEW PLACE

520 N. CHRISTOPHER COLUMBUS BOULEVARD
PHILADELPHIA, PA

TRANSPORTATION MAP



PLEASE CONTACT:

Gregory R. Bianchi

Vice President

T. 215-701-3840

gbianchi@eusrealty.com

Michele Grasso

Managing Director

T. 215-701-3818

michelegrasso@eusrealty.com

Brandon Blue

Sales Associate

T. 215-501-7305

bblue@eusrealty.com

USREALTY
ASSOCIATES, INC.
A Full Service Real Estate Company

120-124 E. Lancaster Avenue - Suite 101 - Ardmore - PA - 19003

T. 215-557-9900 F. 215-701-3839

www.eusrealty.com