

# 1155 S. BLACK HORSE PIKE WILLIAMSTOWN (GLOUCESTER COUNTY), NJ

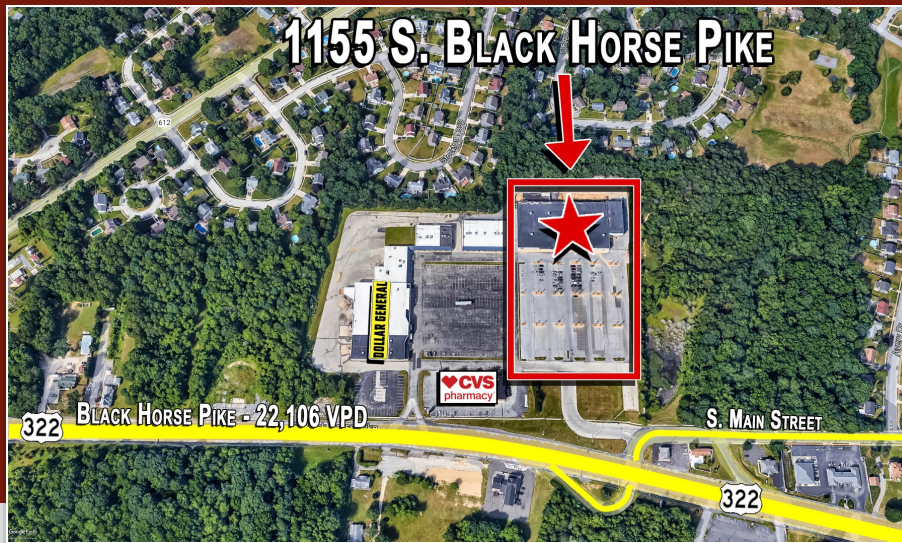

**AVAILABLE**  
**UNITS FROM 2,158 - 29,400 SQUARE FEET**  
**IDEAL FOR RETAIL, RESTAURANT, OFFICE AND FLEX**

## LOCATION

1155 S. Black Horse Pike  
Williamstown (Gloucester County), NJ

## PROPERTY HIGHLIGHTS

- **POTENTIAL TO EXPAND TO 61,240 +/- SF**
- ACRES: 6.63
- Parking: 310 Spaces
- 15' Clear Ceiling Height
- Sprinkled: 100% Wet System
- Adequate Electric Service
- Public Water and Sewer
- Route 322 (Black Horse Pike) Frontage
- Loading Docks, Tailgate and Drive-in Door
- Zoning: RGC (Regional Growth Commercial)



**PLEASE CONTACT:** **Gregory R. Bianchi**  
Vice President  
T. 215-701-3840  
gbianchi@eusrealty.com

**USREALTY**  
ASSOCIATES, INC.  
A Full Service Real Estate Company

120-124 E. Lancaster Avenue - Suite 101 - Ardmore - PA - 19003  
T. 215-557-9900 F. 215-701-3839  
[www.eusrealty.com](http://www.eusrealty.com)



# 1155 S. BLACK HORSE PIKE

## WILLIAMSTOWN (GLOUCESTER COUNTY), NJ

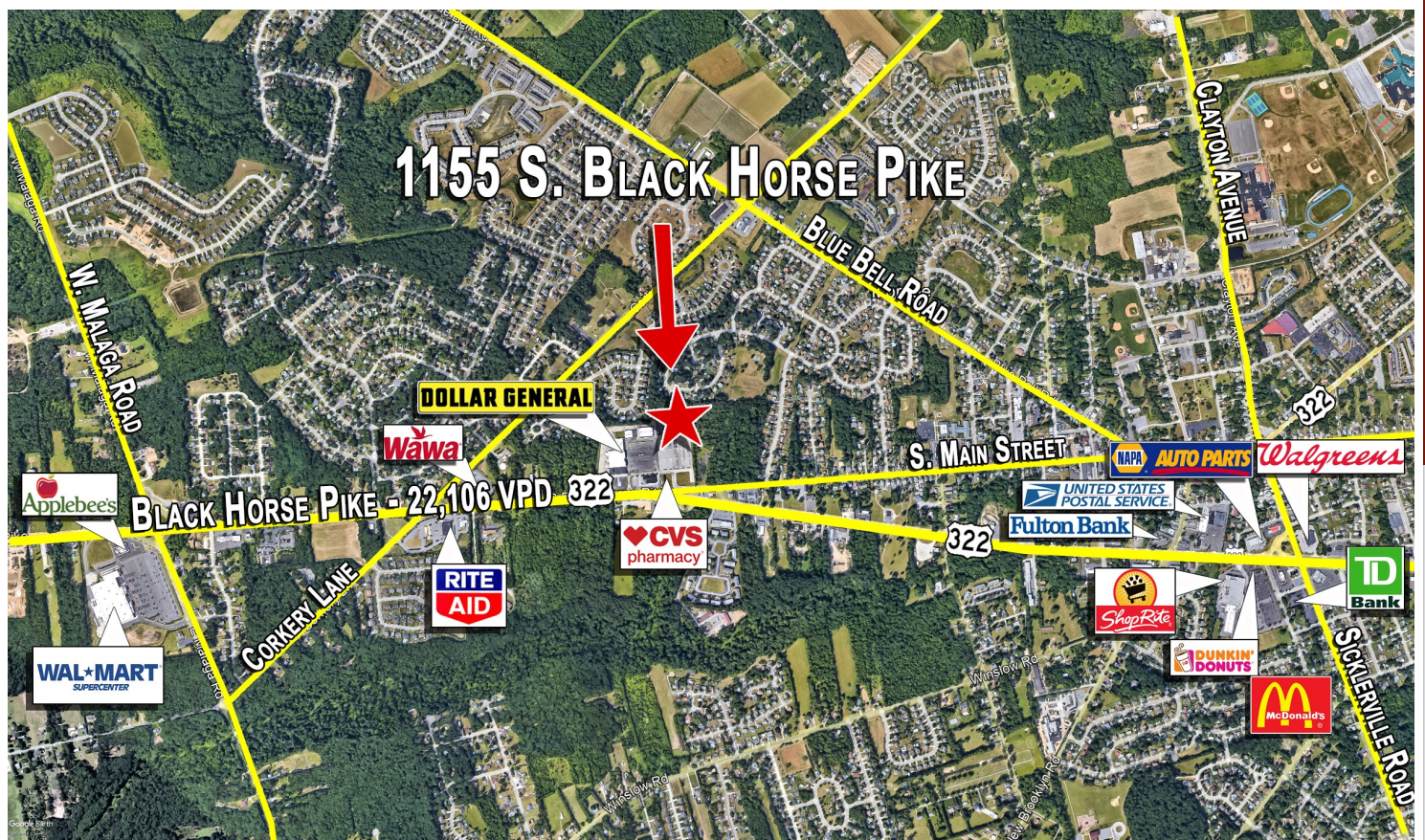

### DEMOGRAPHIC OVERVIEW REPORT

|                    | 1 Mile    | 3 Mile    | 5 Mile    |
|--------------------|-----------|-----------|-----------|
| POPULATION:        | 9,610     | 35,424    | 70,140    |
| HOUSEHOLDS:        | 3,162     | 12,490    | 24,402    |
| AVERAGE HH INCOME: | \$108,303 | \$ 98,616 | \$102,947 |

**PLEASE CONTACT:** Gregory R. Bianchi  
 Vice President  
 T. 215-701-3840  
 gbianchi@eusrealty.com

**EUSREALTY**  
 ASSOCIATES, INC.  
 A Full Service Real Estate Company

120-124 E. Lancaster Avenue - Suite 101 - Ardmore - PA - 19003  
 T.215-557-9900 F. 215-701-3839  
 www.eusrealty.com

The foregoing information was furnished by sources deemed reliable, but no warranty or representation as to its accuracy. Subject to errors, omission, changes of price, prior sale or withdrawal from market without notice.



# 1155 S. BLACK HORSE PIKE

## WILLIAMSTOWN (GLOUCESTER COUNTY), NJ



### FLOOR PLAN

61,420 SQUARE FEET

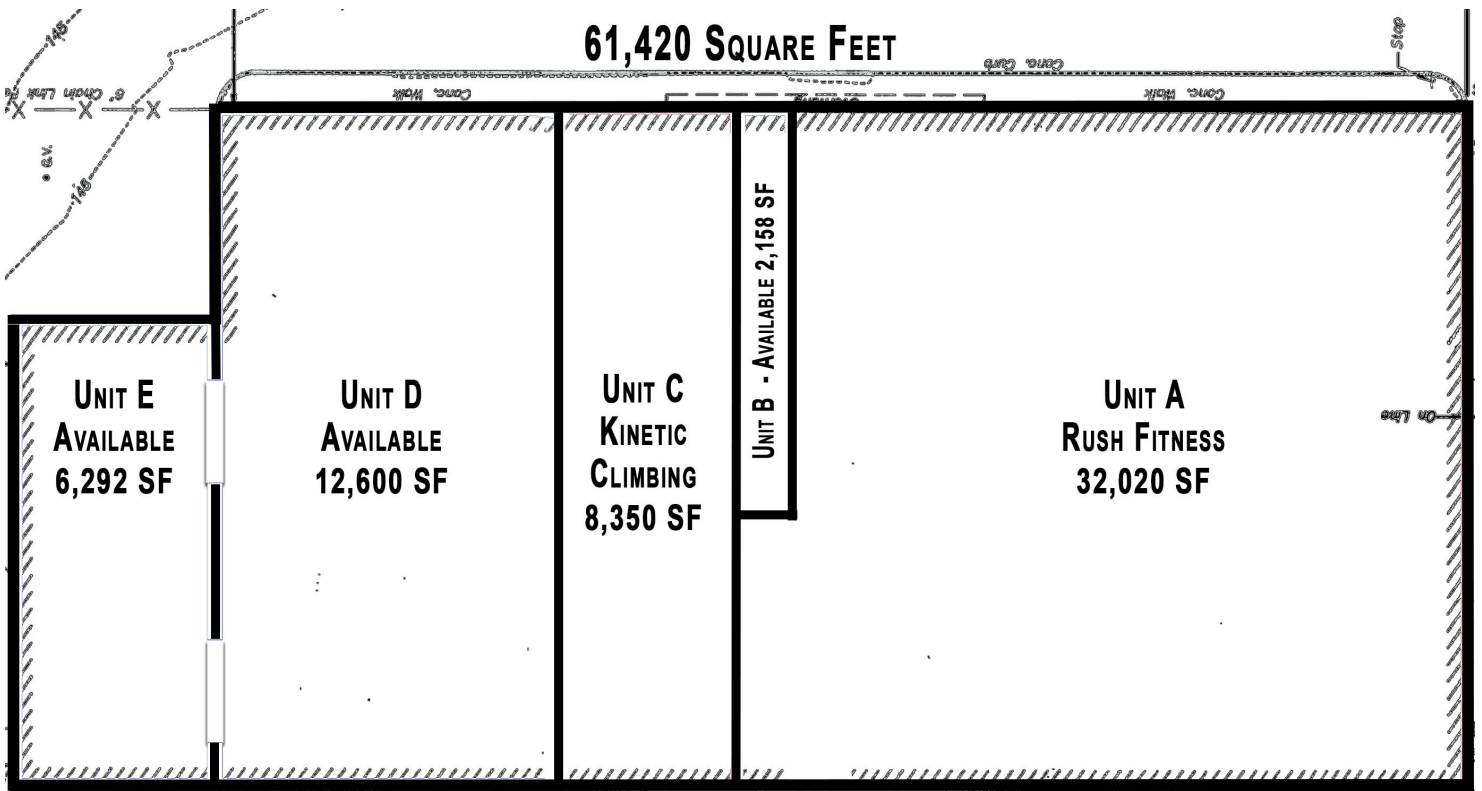

**PLEASE CONTACT:** Gregory R. Bianchi  
Vice President  
T. 215-701-3840  
gbianchi@eusrealty.com

**EUSREALTY**  
ASSOCIATES, INC.  
A Full Service Real Estate Company

120-124 E. Lancaster Avenue - Suite 101 - Ardmore - PA - 19003  
T. 215-557-9900 F. 215-701-3839  
www.eusrealty.com