

24 S. YORK ROAD

HATBORO (MONTGOMERY COUNTY), PA



FOR LEASE

13,800 SF RETAIL SPACE AVAILABLE

LOCATION

24 S. York Road
Hatboro (Montgomery County), PA

PROPERTY HIGHLIGHTS

- 13,800 Square Feet Available
- Free Standing Building
- 110 Feet of Frontage
- 23 Dedicated Parking Spaces
- Additional Township Parking Lot Next Door
- Close Proximity to Bus and Train

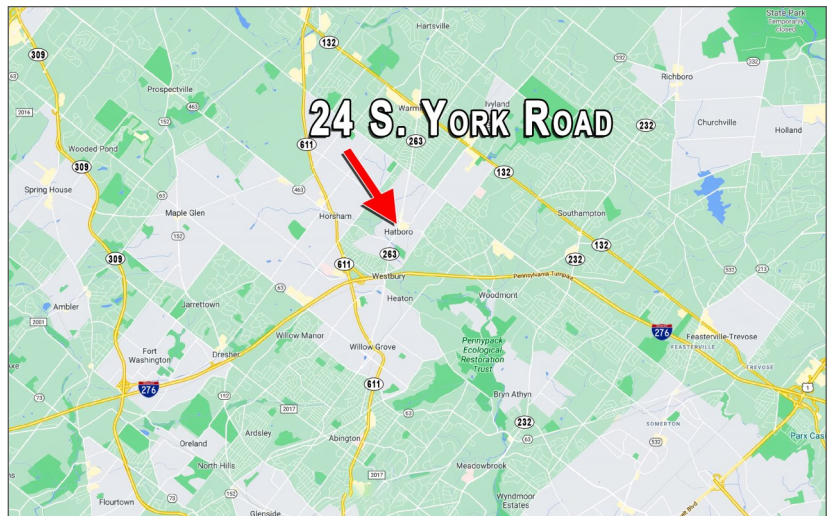

CONTACT:

Brandon Blue
Sales Associate
T. 215-501-7305 M. 267-838-6878
bblue@eusrealty.com

EUSREALTY
ASSOCIATES, INC.
A Full Service Real Estate Company

120-124 E. Lancaster Avenue - Suite 101 - Ardmore - PA - 19003
T. 215-557-9900 F. 215-701-3839
www.eusrealty.com

24 S. YORK ROAD

HATBORO (MONTGOMERY COUNTY), PA

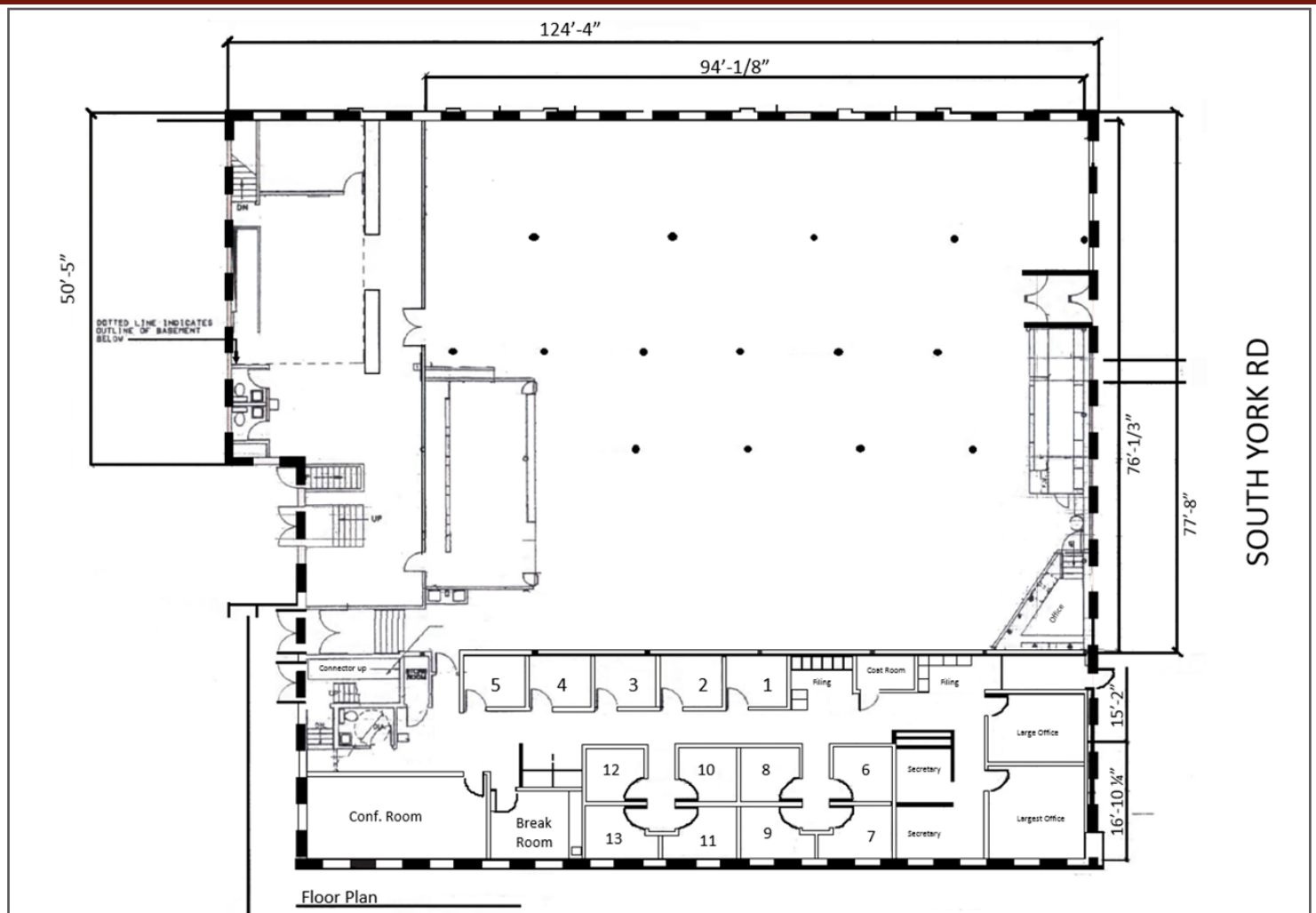

DEMOGRAPHICS

	1 MILE	3 MILE	5 MILE
POPULATION			
2021 TOTAL POPULATION ESTIMATE:	16,996	90,896	196,784
2026 PROJECTION:	17,399	93,086	200,500
HOUSEHOLDS			
2021 AVG. HH INCOME:	\$92,844	\$97,150	\$114,196
EMPLOYEES			
EST. # OF EMPLOYEES	5,030	53,793	108,110

CONTACT: Brandon Blue
 Sales Associate
 T. 215-501-7305 M. 267-838-6878
 bblue@eusrealty.com

EUSREALTY
 ASSOCIATES, INC.
 A Full Service Real Estate Company

120-124 E. Lancaster Avenue - Suite 101 - Ardmore - PA - 19003
 T.215-557-9900 F.215-701-3839
 www.eusrealty.com