

AMERICAN HERITAGE FEDERAL CREDIT UNION PLAZA

280 N. WEST END BOULEVARD
QUAKERTOWN (BUCKS COUNTY), PA



RETAIL/OFFICE - FOR LEASE 4,674 SQUARE FEET - WILL DIVIDE

LOCATION

280 N. West End Blvd. (Along Route 309)
Quakertown (Bucks County), PA

PROPERTY HIGHLIGHTS

- New Construction
- Join American Heritage Federal Credit Union
- From 2,337 to 4,674 Square Feet Available
- March 2020 Delivery
- Great Visibility From Route 309
- Traffic Counts: Route 309 (33,104 VPD)

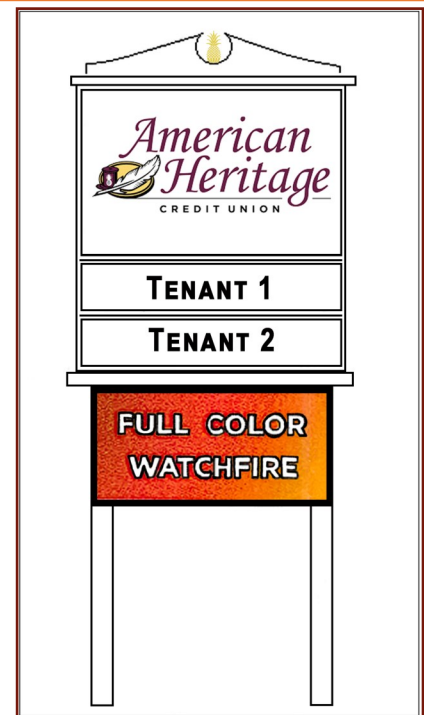

PLEASE CONTACT:

Brandon Blue
Sales Associate
T. 215-501-7305
bbblue@eusrealty.com

USREALTY
ASSOCIATES, INC.
A Full Service Real Estate Company

120-124 E. Lancaster Avenue - Suite 101 - Ardmore - PA - 19003
T.215-557-9900 F.215-701-3839
www.eusrealty.com

AMERICAN HERITAGE FEDERAL CREDIT UNION PLAZA

280 N. WEST END BOULEVARD
QUAKERTOWN (BUCKS COUNTY), PA

SITE PLAN

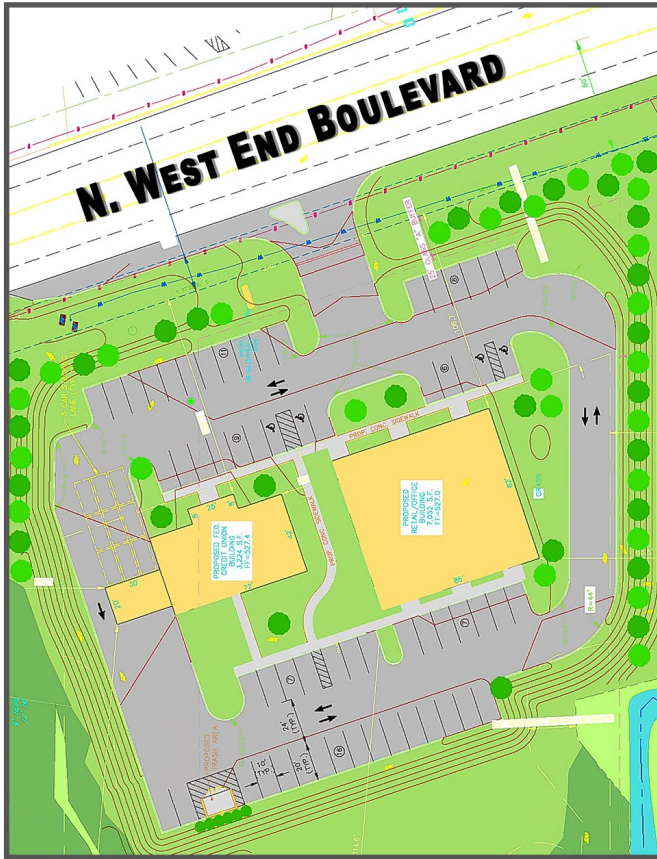

FLOOR PLAN

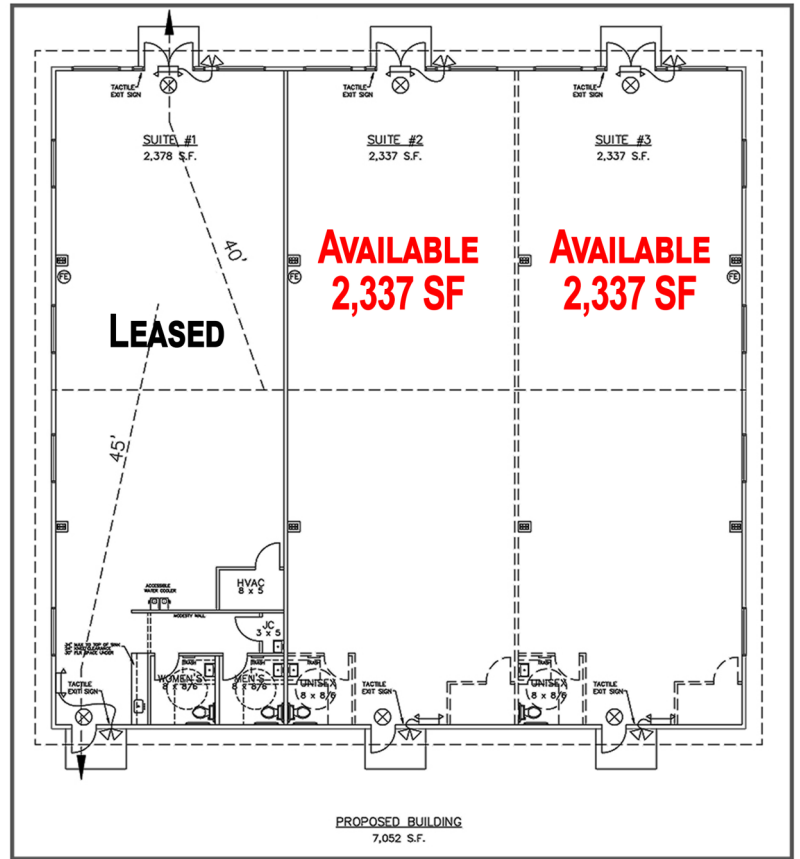

DEMOGRAPHICS

Population	1 Mile	2 Mile	3 Mile
2019 Total Population:	4,585	17,672	28,268
2024 Population:	4,612	17,878	28,488
Pop Growth 2019-2024:	0.59%	1.17%	0.78%
Households			
2019 Total Households:	1,779	6,880	10,740
HH Growth 2019-2024:	0.62%	1.12%	0.74%
Median Household Inc:	\$57,393	\$64,042	\$67,982

PLEASE CONTACT:

Brandon Blue
Sales Associate
T. 215-501-7305
bblue@eusrealty.com



120-124 E. Lancaster Avenue - Suite 101 - Ardmore - PA - 19003
T.215-557-9900 F.215-701-3839
www.eusrealty.com

AMERICAN HERITAGE FEDERAL CREDIT UNION PLAZA

280 N. WEST END BOULEVARD
QUAKERTOWN (BUCKS COUNTY), PA



PLEASE CONTACT:

Brandon Blue
Sales Associate
T. 215-501-7305
bblue@eusrealty.com

USREALTY
ASSOCIATES, INC.
A Full Service Real Estate Company

120-124 E. Lancaster Avenue - Suite 101 - Ardmore - PA - 19003
T. 215-557-9900 F. 215-701-3839
www.eusrealty.com

The foregoing information was furnished by sources deemed reliable, but no warranty or representation as to its accuracy.
Subject to errors, omission, changes of price, prior sale or withdrawal from market without notice.