

THE PAVILION AT QUAKERTOWN

ROUTE 309 & PUMPING STATION ROAD,
QUAKERTOWN, PA

**NOW
LEASING**

**PRIME RETAIL
OPPORTUNITY!**

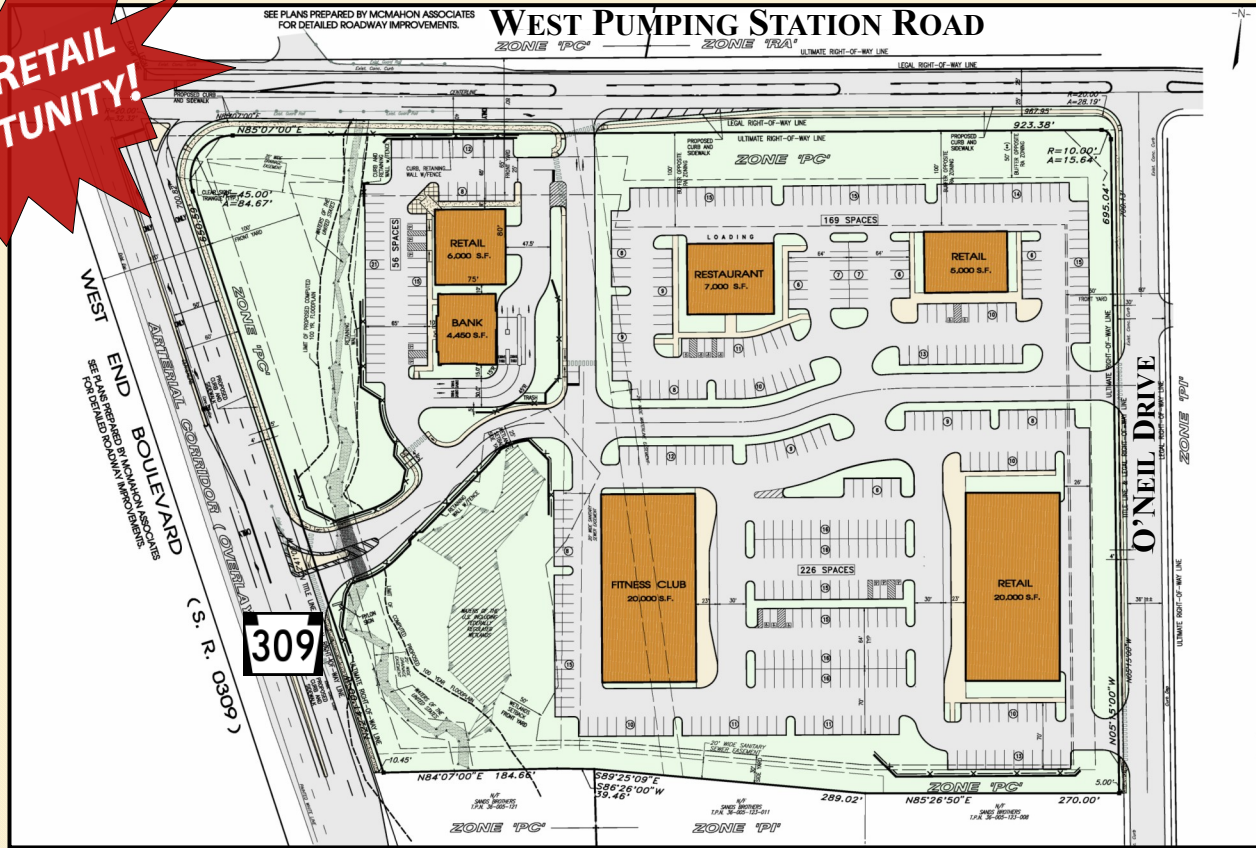

New Bucks County Retail Space

- ◆ 15 Acres +/- of Prime Commercial Zoned Property Available for Lease
- ◆ Fully Approved 14,000 SF Pad Site Available with Drive Thru
- ◆ Anchor, Junior Box and Satellite Stores Available
- ◆ Access to PA Turnpike
- ◆ Major Intersection with Impressive Traffic Counts
- ◆ Join Major Retail Along Route 309 Corridor
- ◆ Located Across from New Target

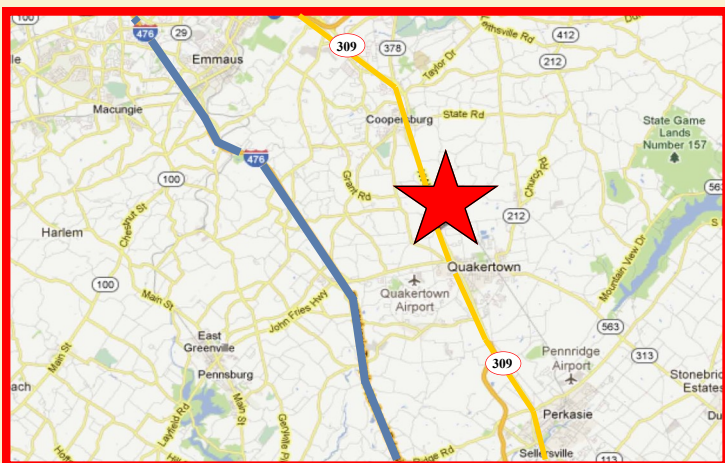

Leasing Info:

Gregory Bianchi Vice President T. 215-557-9900 x 1141 F. 215-701-3839 gbianchi@eusrealty.com	Brandon Blue Sales Associate T. 215-557-9900 x 1126 F. 215-701-3839 bblue@eusrealty.com	Michele Grasso Managing Director T. 215-557-9900 x 1118 F. 215-701-3839 michelegrasso@eusrealty.com
---	--	--



120-124 East Lancaster Avenue - Suite 101
Ardmore, PA 19003
www.eusrealty.com



THE PAVILION AT QUAKERTOWN

BUCKS COUNTY



Demographic Overview Report

Route 309 & West Pumping Station Road, Quakertown, PA

2012	1 Mile	3 Miles	5 Miles
Population	1,388	27,343	47,382
Median HHI	\$ 84,074.00	\$ 63,996.00	\$ 70,118.00
Average HHI	\$119,864.00	\$ 78,019.00	\$ 85,099.00

Route 309: 36,126 VPD

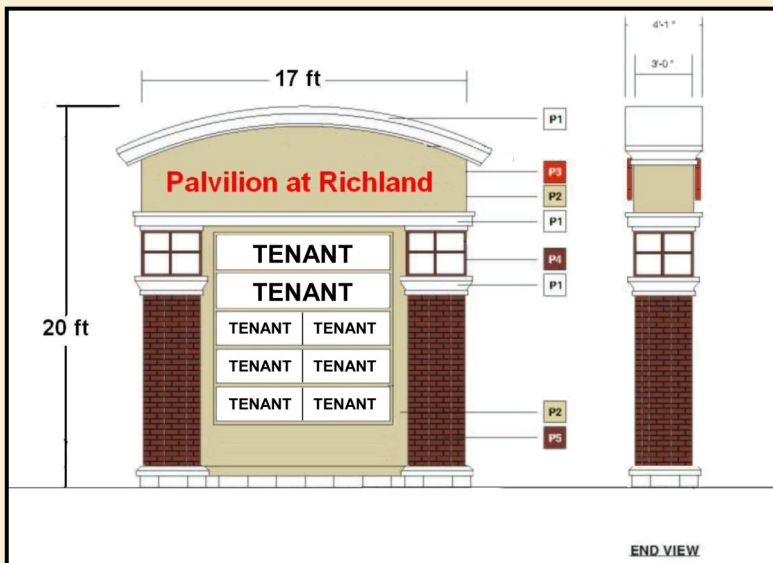

Information provided by reliable sources. Subject to errors, omissions, price change, prior sale or withdrawal from market without notice.

Developed by:



Leased by:



120-124 East Lancaster Avenue
Suite 101
Ardmore, PA 19003
www.eusrealty.com

